



ECL-ACC950

V060612

Networking & Stand-alone Controller
Networking Reader



Front Panel & Indicator

Attendance

Press 1 time	Press 2 times
F1 Duty on	Break out
F2 Duty off	Break RTN
F3 Overtime on	Go
F4 Overtime off	Return

"FUNCTION MENU" INTRODUCTION : The first step you should know !!

Please follow the guide step by step to set up your

Stand-alone / Networking

Mode 4 (Card only Card+PIN PIN+Address)

Mode 8 (Card only Card+Code Code)

Enter into EDIT mode 1

Set Access mode Mode 4, 8 GoTo 2

Access Mode setting Card or PIN Card and PIN GoTo 3

Add Card Holders Enable/Disable or Delete GoTo 4

EXIT

Stand-alone system

Mode 6 (Card only)

Enter into EDIT mode 1

Select Access mode Mode 6 GoTo 2

Access Mode setting Card Only Dureas, Arming GoTo 5

Add Card Holders Enable/Disable or Delete GoTo 6

EXIT

ATTENTION: Please follow the index number to set your machine up.

Quick Guide Function Menu GoTo 7

Function Description GoTo 8

COMMAND LIST

1 Enter into EDIT mode

Press * 123456 # the EDIT MODE will be shown on ECL-ACC950 edit screen

2 Set Access Mode(Mode 4 or 8)

Command: 5 Tools 9. Control Mode 1:M4 2:M6 3:M8 4:M9
1:EMNormal/125k 2: Mifare/13.56Mhz Setting Complete

3 Access Mode setting(Mode 4 or 8)

A. Card Only

- Access the door by flashing card +
- Open door & turn Arming on / off : Flash card. then Press **Arming PWD** + F1
- Not open door & turn arming on / off: Press * **Arming PWD** , then flash card

B. Card and PIN Arming PWD Default Value:1234

- Flash card, then press **PIN Code** + # Door Open
- Flash card, then press **PIN Code** + # and **F1**

COMMAND LIST

3 Access Mode setting

C. User address and PIN Mode 4

- Press keypad: **User address (5 digit) + PIN code + #**
- Open door & turn Arming on / off: Press keypad: **User address (5 digit) + PIN code + #** and then, **Arming PWD + F1**

D. PIN only (Mode 8) Same as Card Only mode

- Door access: **PIN code** (4 digit)
- Open door & turn Arming on / off : **PIN code** + #, then **Arming PWD** + F1
- Not open door & turn arming on / off: Not available

E. Change PIN code

- ECL-ACC950 connects with PC, running 701 client and set PIN code variable. By user: Flash card, then press **PIN code (4 digit) twice + #**
- Not connecting with PC Entering Function menu

F. Dureas function

- This function could help users to send a message to the computer asking for help.
- Only available in networking state, running 701 Server and setting 4 sets of Dureas code on PC. (Anyone of these 4 sets is workable.)
- This function is not available for CARD ONLY access mode and mode 8 directly 4-digit PIN.

Access Mode	Command Format
Card Only	Not available
Card and PIN	Flash card, then press Dureas code + #
Users addr. and PIN (Mode 4)	Press User Address, then Dureas code + #
PIN Only (Mode 8)	Dureas code

4 Add Card Holders

Add user into Reader

- pressing **1 Add/Delete** — **2.Add->RF-learn** Adding Card by reading card !!
- pressing **1 Add/Delete** — **1.Add->Car ID** Adding Card by pressing buttons on keypad !!

Disable(Suspend) Card Holders

- press **1 Add/Delete** — **4.Suspend->ID #** Disable users in ECL-ACC950

Delete Cards (Users)

- press **1 Add/Delete** — **6.Delete->ID #** Remove the card holders

Enable Cards (Users)

- press **1 Add/Delete** — **8.Recover-ID #** Recover Card ID number for Card Holders

5 Access Mode setting(Mode 6)

MODE 6 : Access Mode	
Arming PWD = 0	Card only
Arming PWD ≠ 0	Card and Arming PWD
Dureas Code = 0	Dureas Code not workable
Dureas Code ≠ 0	Dureas Code only

- Default Arming PWD: 1234 : Command: 3/8
press **3 Parameters(1)** — **8.Dureas Code**
- Default Dureas Code: 4321 : Command : 4/8
press **4 Parameters(2)** — **8.Dureas Code**

Under Mode 6, the system built in card code from 0001 to 63200 itself, so user can only suspend or recover cards, not allowed to add or delete.

3.How to know card ID of user address?
(For example: which card ID do we want to know user address 00003) :

- press **1 Add/Delete** — **1.Add->Car ID**
(1) Enter into EDIT MODE
(2) Command 1,1
(3) Enter user address 00003, then you will see card ID.

4. How to know how many users in the system now?
(Not including suspend card)

- press **5 Tools** — **7. Information**
ECL-ACC950 available : 00010 (10 Cards)

Notice

- Each card has 10 digits code, including Site code (5 digits) and Card code (5 digits). Neither the Site Code nor the Card Code numbers can be 0.
- After card editing finished Site Code and Card Code is not important anymore. System will require a USER ADDRESS instead

1. Please visit <http://www.cctvoutlet.com/> to download the operation manual for more detailed information.

2. ECL- ACC950 is also allowed to operate through software please contact your supplier to acquire it.



ECL-ACC950

V060612

Networking & Stand-alone Controller
Networking Reader



COMMAND LIST

6 Add Card Holders Enable Disable , Delete

1. Command for Card Editing :

Disable (Suspend) Cards

press 1. Add/Delete 3.Suspend->Addr

Delete (Disable) Users/Cards

press 1. Add/Delete 5.Delete->Addr
The same as Suspend Users

Recover Cards / Users

press 1. Add/Delete 7 Recover-Addr

2. According to Card ID, use your Card ID to install your card in system.

ex : 1st Card ID is 12345:00001,
the last card ID is 12345:00100

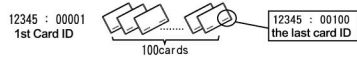

- Steps: 1.Entering into EDIT(Function) Mode
2.Recover : Addr. (command. 17)
3.Input Start Addr. Ex: 00001
4.Input End Addr.Ex: 00100
5.Exit the EDIT mode: finished

7 Quick Guide Function Menu

Under Function Menu, you could just press the indicative number to get into concerning set-up screen directly

1. Add/Delete	2. User Setting	3. Parameters(1)	4. Parameters(2)	5. Tools	6. Quit	7. Quit & Arming
1.Add->Car ID	1.Password	1.Node ID	1.Auto Relock	1.Language		
2.Add->RF-learn	2.Access Mode	2.AutoOpen Zone	2.Egress (R.T.E)	2.Master Code		
3.Suspend->Addr	3.Extend Options	3.Door Relay Tm	3.Attendance	3.Master Range		
4.Suspend->ID #	4.Single Floor	4.Door Close Tm	4.Master Node	4.Terminal Port		
5.Delete->Addr	5.Multi Floors	5.Alarm RelayTm	5.Force Open ...	5.AR401R16 Node		
6.Delete->ID #		6.Alarm DelayTm	6.Close &Stop	6.Open TimeZone.		
7.Recover-Addr		7.ArmingDelayTm	7.Anti-passback	7.1 informations.		
8.Recover-ID #		8.Arming PWD	8.Duress Code	8.Clock Setting		
9.Antipass Group		9.Arming Pulse	9.Factory Reset	9.Control Mode		
			0.Key(#)is Bell	0.View Events		

8 Function Description

24 Single Floor	To setup user for single floor access (This function is only workable under the situation that ECL-ACC950 combined with AR-401RO16 and Control Mode is not Mode 6.)
25 Multi Floors	To setup user for multi floors access(This function is only workable under the situation that ECL-ACC950 combined with AR-401RO16 and Control Mode is not Mode 6.) For example: User 0001 access to floor 17, 22, 31, 32 (Supposed no basement) ① Entering "Function Menu" ④ Select range: 2 (for 17 - 32) ② Press 2 5 1: 01 -16 2: 17 - 32 ③ Enter user address: 00001 ⑤ 0 -> stop 1 -> Yes 10000100000000011
31 Node ID	To setup Node ID (default: 001), range from 001 to 254
33 Door Relay Time	To setup how long the time will be that door close after a card flashing. Range: 0 ~ 600(sec.) To set value "0" will make door keep opening, after 2nd card flashing, then door close. (Default value: 7 sec.)

1. Please visit <http://www.cctvoutlet.com/> to download the operation manual for more detailed information.

Please check your content of packing in ECL-ACC950

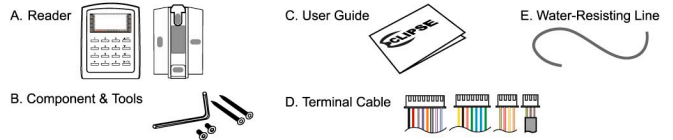

Installation Notice



Steps

- Use the screwdriver to screw the mounting plate on the wall.
- Pull cable ends through the access hole in the mounting plate
- Attach body to the mounting plate and install screw (supplied) into the hole at the bottom with the Allen wrench(supplied).
- Apply power. Green LED(Power) will light up, a beep sound and LCD panel message will show up.

Installation Notice:

- The distance between Reader and its auxiliary reader should be more than 50cm and less than 12 M. (suggested value)
- Reader does not supply power to operate electric strike or magnetic locks, a separated power supply are required.
- Run the following cables to Reader location. Conduit is recommended to reduce the effects of EMI/RFI and for physical protection of the wires.

Installation Diagram

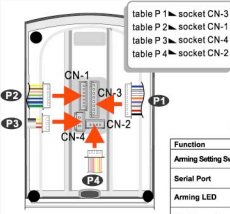

P3 Table3-Connector CN4 Color Coding

Wire Application	Wire	Color	Description
Tamper Switch	1	Red	N.C.
	2	Orange	COM
	3	Yellow	N.O.

P1 Table1-Connector CN3 Color Coding

Wire Application	Wire	Color	Description
Door Relay	1	Blue White	N.O. JCC24V1/Amp
	2	Purple White	N.C. JCC24V1/Amp
Door/Alarm Relay	3	White	COM/JCC24V1/Amp
Door Sensor	4	Orange	Negative Trigger Input
Exit Switch	5	Purple	Negative Trigger Input
Alarm Relay	6	Gray	N.O. / N.C. Optional
Power	7	Thick Red	DC Power 12V
	8	Thick Black	DC Power 0V

P4 Table4-Connector CN2 Color Coding

Function	Wire	Color	Description
Arming Setting Switch	1	Orange White	ON - OFF Latch type
Serial Port	2	Yellow White	Serial output (Transistor open collector) (4800,N.S.1)
Arming LED	3	Red White	Arming output (Active low)
Card Present	4	Brown White	Card present output active low (Transit output)

P2 Table2-Connector CN1 Color Coding

Wire Application	Wire	Color	Description
Networking	1	Thick Green	RS-485(B)
	2	Thick Blue	RS-485(A)
	3	Thick Blue	Wiegand DAT1 Input
Wiegand	4	Thin Green	ABA Clock Input
	5	Wiegand DAT0 Input	ABA Data Input
Buzzer	6	Pink	Buzzer Output 5V/100mA, Low
LED	6	Brown	LED Green Output 5V/20mA, Max
	7	Yellow	LED Red Output 5V/20mA, Max

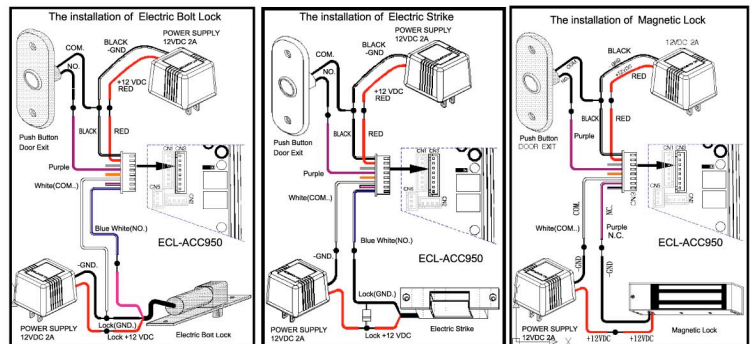

2. ECL-ACC950 is also allowed to operate through software please contact your supplier to acquire it.